

**OPAC Database**  
 You can check the book shelf location by using the OPAC system. You can do this via the homepage or you can use the PCs in the library.



**Foreign Books**  
 Foreign language books are located here.

Please note that newspapers, reference books and the latest issues of magazines are not available for rental. Please use them in the library only. You can, however, borrow past issues of magazines.



**Seating area**  
 Why don't you enjoy a leisurely read in the bright reading seats facing the courtyard?

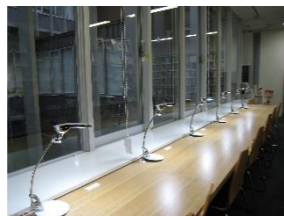

**Book review aisle**  
 A passage from the media booth to a viewing space which displays books introduced in newspapers.



**Browsing corner**  
 Flip through newspapers and magazines, and read recommended books and guidebooks. Chairs and tables are movable.



**Counter**  
 Please consult here for queries on how to use the library or how to search for materials. You can also enquire here for copying documents, using interlibrary loans, and for requesting a letter of introduction in order to visit another university.

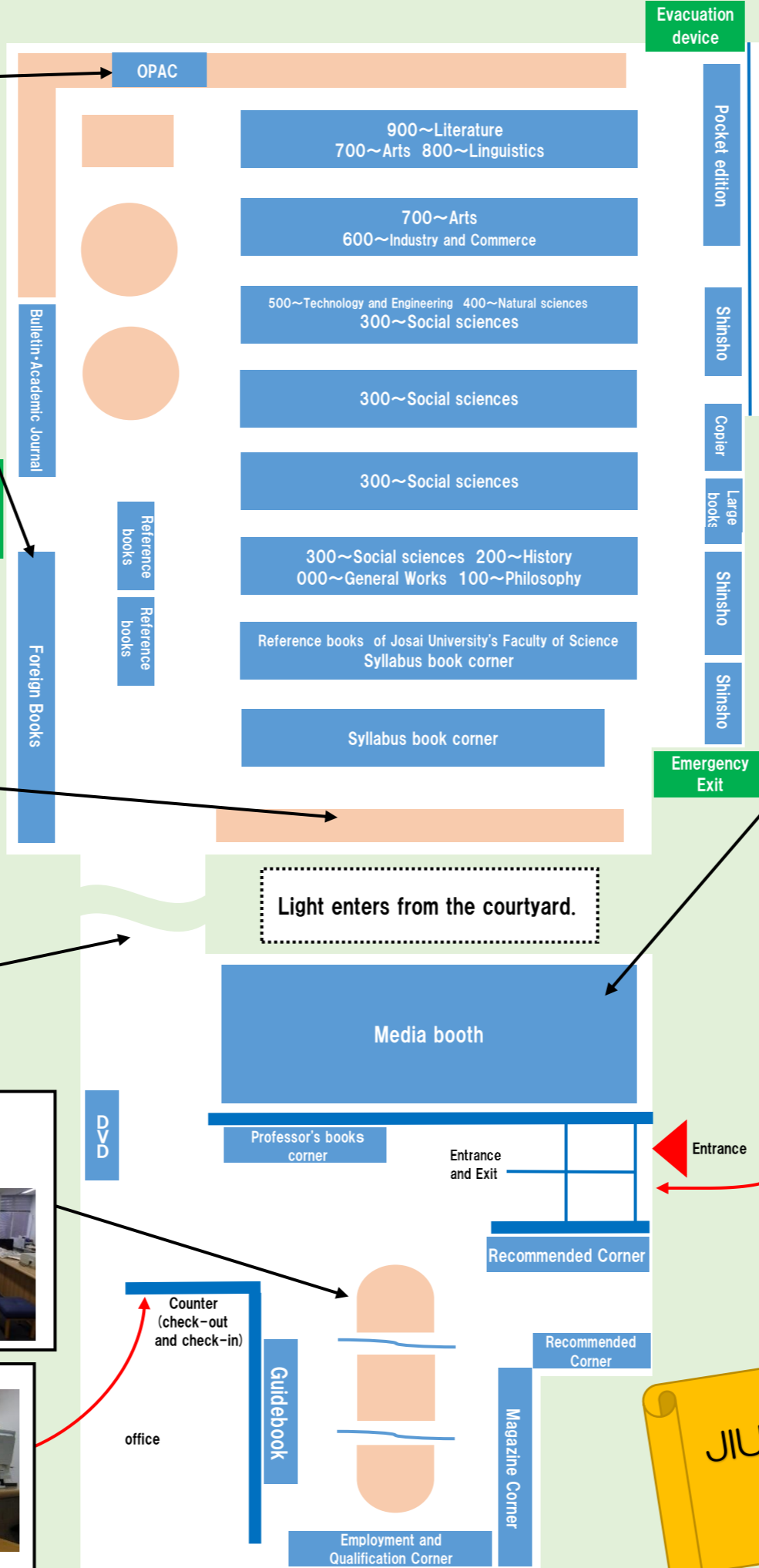

**Closed archive**

This color on the map marks the seating areas.

**Closed archive**  
 Materials located in the shelving area marked 「書庫(紀尾井町)」 (eng. closed archive) are stored here. For example, old magazines and books. Please enquire at the counter if you wish to use them.



Eating and drinking is not allowed in the library. Please eat and drink outside the library.

**Media booth**  
 You can go to the Circulation desk to access audio-visual materials, and enjoy using them in the library. Please note that they are only available for use within the library.

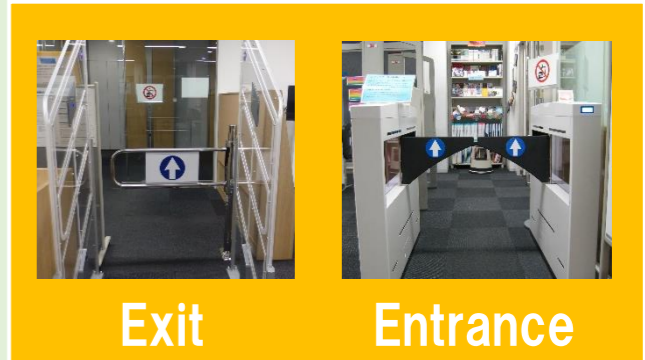

**Library Entrance**  
 The library is located on the 2nd floor of Building No.1. You can see the entrance when walking into the office. Please scan your student ID when entering.



2nd Floor

**JIU MIZUTA MEMORIAL LIBRARY map**  
 Kioicho Campus